

3-WAY BALL VALVE THREAD END DIRECT MOUNTING PAD

三通高平台螺纹球阀

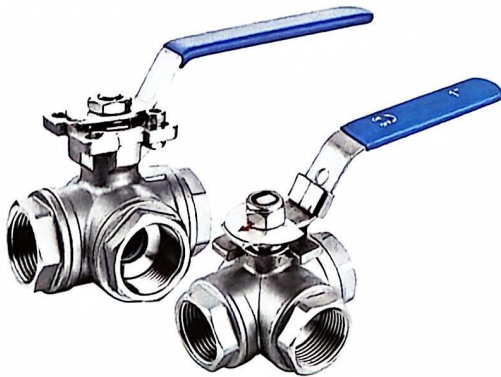

特点 Features

- 缩径 T型 / L型 Reduced port T port / L port, 1/4"~3" (DN6~DN80)
- 工作压力 W.P.: 1000WOG (PN63)
- 工作温度 W.T.: -20°C~180°C
- 精密铸造 Investment casting
- 阀杆防爆出装置设计 Blow-out proof stem
- 双蝶形弹簧动负载设计 Live-loading design
- 防静电装置 (可选) Anti-static device (option)
- 4个阀座设计 There are four seats
- 360° 旋转手柄 360° Rotary handle
- 手柄带锁装置 (可选) Locking device handle (option)
- ISO5211直装高平台设计 ISO 5211 Direct mounting pad
- 自动化装置 (可选) Automation accessories (option)
- 螺纹连接标准 Thread type: ASME B1.20.1 (NPT),
DIN 259 / DIN 2999, BS 21,
ISO 288-1, ISO 7-1

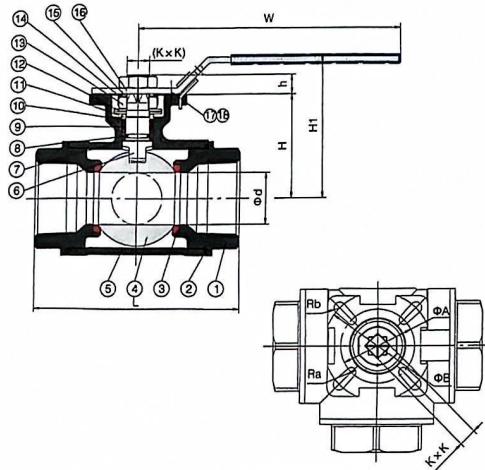

材料表 Material List

序号No.	零件 PARTS	材料 MATERIAL		
1	阀盖 BONNET	WCB	CF8	CF8M
2	垫片 GASKET	PTFE		
3	阀座 SEAT	PTFE		
4	球体 BALL	CF8	CF8	CF8M
5	阀体 BODY	WCB	CF8	CF8M
6	阀杆 STEM	304	304	316
7	阀杆垫圈 STEM WASHER	PTFE+25% GF		
8	O 形圈 O-RING	FPM		
9	填料 PACKING	PTFE		
10	耐磨垫圈 WEAR WASHER	PTFE+25% GF		
11	填料盖 GLAND	304		
12	碟形弹簧 DISC SPRING	304		
13	螺母 NUT	304		
14	CROWN WASHER	304		
15	垫圈 WASHER	304		
16	手柄 HANDLE	304+PVC		
17	六角螺栓 HEX SOCKET BOLT	304		
18	螺母 NUT	304		

尺寸 Dimensions

Unit: mm

尺寸 SIZE	d	L	H	h	KxK	A	B	Ra	Rb	W	H1	
1/4"	DN6	10	69	34	9	9×9	36	42	3.0	3.0	125	62
3/8"	DN10	10	69	34	9	9×9	36	42	3.0	3.0	125	62
1/2"	DN15	10	71	34	9	9×9	36	42	3.0	3.0	125	62
3/4"	DN20	15	84	42	9	9×9	36	42	3.0	3.0	125	70
1"	DN25	18	89	52	9	9×9	42	50	3.0	3.5	140	82
1-1/4"	DN32	25	117	58	11	11×11	42	50	3.0	3.5	140	88
1-1/2"	DN40	32	133.5	67	14	14×14	50	70	3.5	4.5	180	97
2"	DN50	40	148	78	14	14×14	50	70	3.5	4.5	180	108
2-1/2"	DN65	50	170	97	17	17×17	70	102	4.5	5.5	260	133
3"	DN80	65	237	112	17	17×17	70	102	4.5	5.5	260	148