

法兰类型 Type of Flange	密封面形式 Type of Sealing Surface	压力等级 Pressure Class(Mpa)	制造标准 Manufacturing Standard
 板式平焊法兰(PL)Plate Flange	突面(RF)	0.25-2.5	可采用 GB/T9112-9124 HG20592-20635 SH3406 ANSIB16.5 JISB2220 ASME B16.47 等标准制造
	全平面(FF)	0.25-1.6	
 带颈平焊法兰(SO)Slip-on Flange	突面(RF)	0.6-0.4	
	凹凸面(MFM)	1.0-4.0	
	榫槽面(TG)	0.6-1.6	
 带颈对焊法兰(WN)Welding Neck Flange	全平面(FF)	1.0-25.0	
	突面(RF)	1.0-16.0	
	凹凸面(MFM)	1.0-16.0	
	榫槽面(TG)	6.3-25.0	
 承插焊法兰(SW)Socket Welding Flange	连环端面(RJ)	1.0-1.6	
	全平面(FF)	1.0-10.0	
	突面(RF)	1.0-10.0	
 螺纹法兰(THD)Threaded Flange	凹凸面(MFM)	1.0-10.0	
	榫槽面(TG)	0.6-0.4	
	突面(RF)	0.6-1.6	
 对焊环松套法兰(LF/SE)Butt Welding Ring Loose Flange	全平面(FF)	0.6-4.0	
	突面(RF)	0.6-1.6	
 平焊环松套法兰(RJ/RJ)Flat Welding Ring Loose Flange	突面(RF)	1.6-1.6	
	凹凸面(MFM)	1.0-1.6	
	榫槽面(TG)	1.0-1.6	
 法兰盖(BL)Blind Flange	突面(RF)	0.25-0.25	
	凹凸面(MFM)	1.0-16.0	
	榫槽面(TG)	1.0-16.0	
	连环端面(RJ)	6.3-25.0	
	全平面(FF)	0.25-1.6	
 衬里法兰盖(BL(S))Lining Blind Flange	突面(RF)	0.6-4.0	
	凹凸面(MFM)	1.0-4.0	
	榫槽面(TG)	1.0-4.0	

钢制法兰(美洲体系) STEEL FLANGE(AMERICAN SYSTEM)

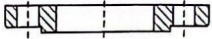

带颈对焊法兰(WN)Welding Neck Flange(①)

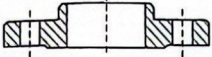
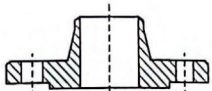
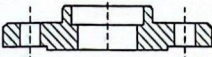
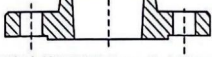
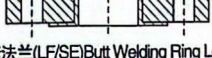
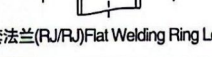
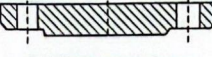
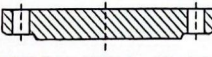
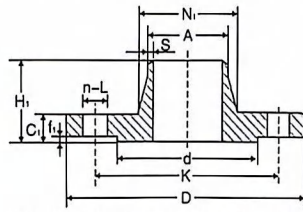
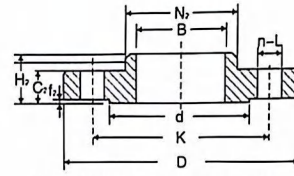

带颈平焊法兰(SO)Slip-on Flange(②)

美洲体系法兰Class150(PN2.0Mpa)American System Flange Class 150(PN2.0Mpa)

公称直径 Nominal Diameter	钢管 外径 Hub Diam Top	法兰 外径 O D Of Flange	突台 直径 Raised Face Diam	螺栓 中心 圆直径 Diam Of Bolt Circle	螺栓孔 直径 Diam of Bolt Holes	螺栓孔 数量 No of Bolt Holes	螺栓 承插 直径 of Bolt (inch)	法兰 厚度 Thickness of Flange	颈部 直径 Diam Of Hub	法兰高度 Length Through Hub			法兰近似重量 (KG) Approximate Weight of Flange				
										H1	H2	H3	W1	W2	W3	W4	
DN	NPS	A	D	d	K	L	n	Th	C1-L	N	H1	H2	H3	W1	W2	W3	W4
15	1/2	21.3	90	35	60.5	16	4	M14	11.5	30	48	16	16	0.65	0.42	0.53	0.43
20	3/4	26.9	100	43	70	16	4	M14	13	38	52	16	16	0.91	0.6	0.73	0.63
25	1	33.7	110	51	79.5	16	4	M14	14.5	49	56	17	17	1.14	0.83	0.89	0.89
(32)	(1 1/4)	42.4	120	63.5	89	16	4	M14	16	59	57	21	21	1.46	1.12	1.17	1.2
40	1 1/2	48.3	130	73	98.5	16	4	M14	17.5	65	62	22	22	1.86	1.43	1.48	1.58
50	2	60.3	150	92	120.5	18	4	M16	19.5	78	64	25	25	2.72	2.07	2.1	2.39
(65)	(2 1/2)	76.1	180	105	139.5	18	4	M16	22.5	90	70	29	29	4.45	3.53	3.56	4.07
80	3	88.9	190	127	152.5	18	4	M16	24	108	70	30	30	5.22	4.01	3.96	4.92
(90)	(3 1/2)	101.6	216	140	178	18	8	M16	24	122	71	-	32	5.45	-	4.99	5.9
100	4	114.3	230	157.5	190.5	18	8	M16	24	135	76	33	33	7.49	5.4	5.57	7.13
125	(5)	139.7	255	186	216	22	8	M20	24	164	89	36	36	9.53	6.29	6.33	9.31
(150)	6	168.3	280	216	241.5	22	8	M20	25.5	192	89	40	40	11.8	7.82	7.67	11.7
200	8	219.1	345	270	298.5	22	8	M20	29	246	102	44	45	19.17	12.75	12.67	20.46
250	10	273	405	324	362	26	12	M24	30.5	305	102	49	49	25.67	16.78	16.56	29.19
300	12	323.9	485	381	432	26	12	M24	32	365	114	56	56	39.9	26.91	27.2	44.11
350	14	355.6	535	413	476	29.5	12	M27	35	400	127	57	79	53.3	35.24	39.29	58.83
400	16	406.4	600	470	540	29.5	16	M27	37	457	127	64	87	68.5	46.46	52	78.19
450	18	457	635	533.5	578	32.5	16	M30	40	505	140	68	97	79.99	49.26	56.21	94.72
500	20	508	700	584	635	32.5	20	M30	43	559	145	73	103	101	62.94	73.4	123.6
550	22	559	750	641	692	35.5	20	M33	46	610	149	-	-	113.5	-	-	150.7
600	24	610	816	692	749.5	35.5	20	M33	48	664	152	83	111	139	88.11	99.83	187.1

注释 Note:

1)①带颈对焊法兰WN;②带颈平焊法兰SO、螺纹法兰THD、承插法兰SW; ③活套法兰LJ; ④法兰盖BL。

①Welding Neck Flange(WN),②Slip-on Flange(SO),Threaded Flange(THD),Socket Welding Flange(SW),③Lap Joint Flange(LJ),④

Blind Flange(BL).

2)可按ASME B16.5、HG20615-20622、ASME B16.36、ASME B16.48、SH3406、GB9112-9124、GB/T2506、GB/T4450等标准制造。

ASME B16.5、HG20615-20622、ASME B16.36、ASME B16.48、SH3406、GB9112-9124、GB/T2506、GB/T4450 specifications

are available.

钢制法兰(美洲体系) STEEL FLANGE(AMERICAN SYSTEM)

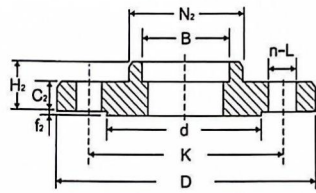

承插焊法兰(SW)Socket Welding Flange(②)

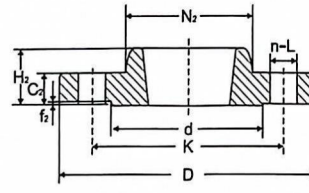

螺纹法兰(THD)Threaded Flange(②)

美洲体系法兰 Class300(PN5.0Mpa)American System Flange Class300(PN5.0Mpa)

公称直径 Nominal Diameter	钢管外径 Hub Diam. Top	法兰外径 O.D. Of Flange	突台直径 Raised Face Diam.	螺栓中心 圆直径 Diam. Of Bolt Circle	螺栓孔 直径 Diam. of Bolt Holes	螺栓孔 数量 No. of Bolt Holes	螺栓尺寸 Diam. of Bolt (Inch)	法兰厚度 Thickness of Flange	颈部直径 Diam. Of Hub	法兰高度 Length Through Hub			法兰近似重量(KG) Approximate Weight of Flange			
										H1	H2	H3	W1	W2	W3	W4
15	1/2	21.3	95	35	66.5	4	M14	14.5	38	52	22	22	0.91	0.64	0.71	0.63
20	3/4	26.9	120	43	82.5	4	M16	16	48	57	25	25	1.36	1.16	1.26	1.15
25	1	33.7	125	51	89	4	M16	17.5	54	62	27	27	1.82	1.37	1.47	1.4
(32)	(1 1/4)	42.4	135	63.5	98.5	4	M16	19.5	64	65	27	27	2.27	1.76	1.86	1.88
40	1 1/2	48.3	155	73	114.5	4	M20	21	70	68	30	30	3.18	2.53	2.65	2.65
50	2	60.3	165	92	127	8	M16	22.5	84	70	33	33	3.79	2.91	2.98	3.38
(65)	(2 1/2)	76.1	190	105	149	8	M20	25.5	100	76	38	38	5.74	4.43	4.47	5.09
80	3	88.9	210	127	168.5	8	M20	29	118	79	43	43	8.17	6.16	6.14	7.22
(90)	(3 1/2)	101.6	229	140	184	8	M20	30	140	81	45	45	9.1	7.72	7.26	9.53
100	4	114.3	255	157.5	200	8	M20	32	146	86	48	48	12.1	9.74	10.05	11.62
(125)	(5)	139.7	280	186	235	8	M20	35	178	98	51	51	16.3	12.4	12.56	15.76
150	6	168.3	320	216	270	12	M20	37	206	98	52	52	21.29	16.76	16.42	22.16
200	8	219.1	380	270	330	12	M24	41.5	260	111	62	62	32.2	24.93	24.42	35.14
250	10	273	445	324	387.5	16	M27	48	321	117	67	95	47.01	35.59	38.85	54.99
300	12	323.9	520	381	451	16	M30	51	375	130	73	102	66.64	50.91	55.75	79.96
350	14	355.6	585	413	514.5	20	M30	54	426	143	76	111	95.69	72.6	81	108.4
400	16	406.4	650	470	571.5	20	M33	57.5	483	146	83	121	121	91.63	104.9	141.2
450	18	457	710	533.5	628.5	24	M33	60.5	533	159	89	130	150.2	111.6	128.6	178.8
500	20	508	775	584	686	24	M33	63.5	587	162	95	140	181.6	136	156	223.3
(550)	(22)	559	840	641	743	24	M39	66.5	640	165	-	-	199.4	-	-	268.7
600	24	610	915	692	813	24	M39	70	702	168	104	152	265	202.1	235.1	342

注释 Note:

①带颈对焊法兰WN;②带颈平焊法兰SO、螺纹法兰THD、承插法兰SW;③活套法兰LJ;④法兰盖BL。

①Welding Neck Flange(WN),②Slip-on Flange(SO), Threaded Flange(THD), Socket Welding Flange(SW),③Lap Joint Flange(LJ),④Blind Flange(BL)

钢制法兰(美洲体系) STEEL FLANGE(AMERICAN SYSTEM)

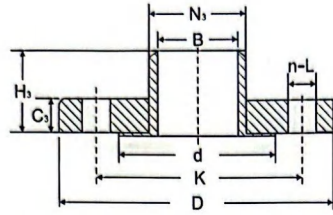

对焊环松套法兰(LF/SE)Butt Welding Ring Loose Flange(③)

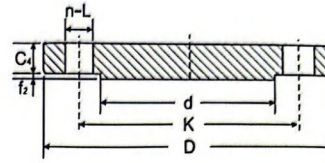

法兰盖(BL)Blind Flange(④)

美洲体系法兰 Class600(PN11.0Mpa)American System Flange Class600(PN11.0Mpa)

公称直径 Nominal Diameter	钢管外径 Hub Diam.Top	法兰外径 O.D.Of Flange	突台直径 Raised Face Diam.	螺栓中心 圆直径 Diam.Of Bolt Circle	螺栓孔 直径 Diam.of Bolt Holes	螺栓孔 数量 No.of Bolt Holes	螺栓尺寸 Diam.of Bolt (inch)	法兰厚度 Thickness of Flange	颈部直径 Diam.Of Hub	法兰高度 Length Through Hub	法兰近似重量(KG) Approximate Weight of Flange						
DN	NPS	A	D	d	K	L	n	Th	C1-4	N	H1	H2	H3	W1	W2	W3	W4
15	1/2	21.3	95	35	66.5	16	4	M14	14.5	38	52	22	22	1.36	0.75	0.76	0.77
20	3/4	26.9	120	43	82.5	18	4	M16	16	48	57	25	25	1.59	1.35	1.38	1.37
25	1	33.7	125	51	89	18	4	M16	17.5	54	62	27	27	1.86	1.58	1.62	1.66
(32)	(1 1/4)	42.4	135	63.5	98.5	18	4	M16	21	64	67	29	29	2.57	2.15	2.23	2.37
40	1 1/2	48.3	155	73	114.5	22	4	M20	22.5	70	70	32	32	3.63	2.99	3.09	3.29
50	2	60.3	165	92	127	18	8	M16	22.5	84	73	37	37	4.54	3.71	3.85	4.24
(65)	(2 1/2)	76.1	190	105	149	22	8	M20	29	100	79	41	41	6.39	5.2	5.50	6.24
80	3	88.9	210	127	168.5	22	8	M20	32	117	83	46	46	8.49	7.13	7.74	8.63
(90)	(3 1/2)	101.6	229	140	184	26	8	M24	35	133	86	49	49	11.8	9.53	9.08	13.17
100	4	114.3	275	157.5	216	26	8	M24	38.5	152	102	54	54	17.46	14.9	15.4	17.74
(125)	(5)	139.7	330	186	267	29.5	8	M27	44.5	189	114	60	60	30.9	24.99	25.1	29.98
150	6	168.3	355	216	292	29.5	12	M27	48	222	117	67	67	33.96	29.96	29.8	37.35
200	8	219.1	420	270	349	32.5	12	M30	55.5	273	133	76	76	52.23	44.87	45.2	60.65
250	10	273	510	324	432	35.5	16	M33	63.5	343	152	86	111	86.02	72.84	80.2	100.2
300	12	323.9	560	381	489	35.5	20	M33	67	400	156	92	117	102.9	85.89	97.1	126.5
350	14	355.6	605	413	527	39	20	M36	70	432	165	94	127	157.5	101.7	116.2	154.3
400	16	406.4	685	470	603	42	20	M39	76.5	495	178	106	140	218.4	144.1	164.2	216.9
450	18	457	745	533.5	654	45	20	M42	83	546	184	117	152	252.0	177.4	218.5	278
500	20	508	815	584	724	45	24	M42	89	610	190	127	165	313.3	225.3	275.7	355.5
(550)	(22)	559	870	641	778	48	24	M45	95	665	197	-	-	376.5	-	-	428.5
600	24	610	940	692	838	51	24	M48	102	718	203	140	184	443.6	314	367.1	537.1

注释 Note:

①带颈对焊法兰WN; ②带颈平焊法兰SO、螺纹法兰THD、承插法兰SW; ③活套法兰LJ; ④法兰盖BL。

①Welding Neck Flange(WN),②Slip-on Flange(SO),Threaded Flange(THD),Socket Welding Flange(SW),③Lap Joint Flange(LJ),④Blind Flange(BL)。

钢制法兰(美洲体系) STEEL FLANGE(AMERICAN SYSTEM)

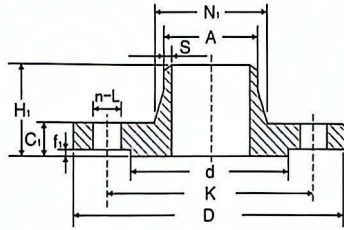

带颈对焊法兰(WN)Welding Neck Flange(①)

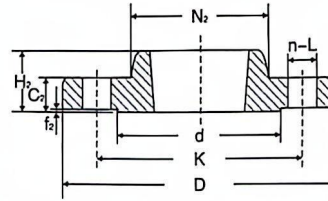

螺纹法兰(THD)Threaded Flange(②)

美洲体系法兰 Class900(PN15.0Mpa)American System Flange Class900(PN15.0Mpa)

公称直径 Nominal Diameter		钢管外径 Hub Diam Top	法兰外径 O. D Of Flange	突台直径 Raised Face Diam	螺栓中心 圆直径 Diam. Of Bolt Circle	螺栓孔 直径 Diam. of Bolt Holes	螺栓孔 数量 No of Bolt Holes	螺栓尺寸 Diam of Bolt (inch)	法兰厚度 Thickness of Flange	颈部 直径 Diam Of Hub		法兰高度 Length Through Hub			法兰近似重量(KG) Approxim Weight of Flange		
DN	NPS	A	D	d	K	L	n	Th	C1-4	N	H1	H2	W1	W2	W3		
15	1/2	21.3	120	35	82.5	22	4	M20	22.5	38	60	32	3.18	1.75	1.78		
20	3/4	26.9	130	43	89	22	4	M20	25.5	44	70	35	3.18	2.35	2.43		
25	1	33.7	150	51	101.5	26	4	M24	29	52	73	41	3.86	3.5	3.65		
(32)	(1 1/4)	42.4	160	63.5	111	26	4	M24	29	64	73	41	4.54	4.01	4.27		
40	1 1/2	48.3	180	73	124	29.5	4	M27	32	70	83	44	6.36	5.52	5.94		
50	2	60.3	215	92	165	26	8	M24	38.5	105	102	57	10.9	9.81	10.05		
(65)	(2 1/2)	76.1	245	105	190.5	29.5	8	M27	41.5	124	105	64	16.3	13.5	14.05		
80	3	88.9	240	127	190.5	26	8	M24	38.6	127	102	54	13.44	11.5	18.09		
100	4	114.3	290	157.5	235	32.5	8	M30	44.5	159	114	-	23.2	-	21.83		
(125)	(5)	139.7	350	186	279.5	35.5	8	M33	51	190	127	-	39.1	-	37.36		
150	6	168.3	380	216	317.5	32.5	12	M30	56	235	140	-	49.9	-	48.63		
200	8	219.1	470	270	393.5	39	12	M36	63.5	298	162	-	86.91	-	91		
250	10	273	545	324	470	39	16	M36	70	368	184	-	121.7	-	124		
300	12	323.9	610	381	533.5	39	20	M36	79.5	419	200	-	168.9	-	174.8		
350	14	355.6	640	413	559	42	20	M39	86	451	213	-	255.2	-	208		
400	16	406.4	705	470	616	45	20	M42	89	508	216	-	311.0	-	262.8		
450	18	457	785	533.5	686	51	20	M48	102	565	229	-	419.5	-	369.6		
500	20	508	855	584	749.5	55	20	M52	108	672	248	-	528.5	-	461.0		
600	24	610	1040	692	901.5	68	20	M64	140	749	267	-	956.6	-	874.5		

注释 Note:

①带颈对焊法兰WN; ②承插法兰SW; ④法兰盖BL。

①Welding Neck Flange(WN),②Socket Welding Flange(SW),④Blind Flange(BL)。

钢制法兰(美洲体系) STEEL FLANGE(AMERICAN SYSTEM)

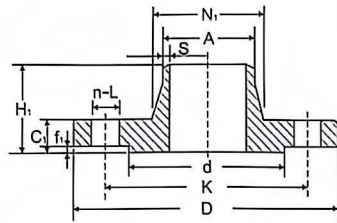

带颈对焊法兰(WN)Welding Neck Flange(①)

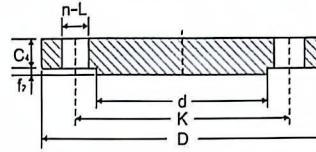

法兰盖(BL)Blind Flange(④)

美洲体系法兰 Class 1500(PN26.0Mpa)American System Flange Class 1500(PN26.0Mpa)

公称直径 Nominal Diameter		钢管外径 Hub Diam Top	法兰外径 O.D. Of Flange	突台直径 Raised Face Diam	螺栓中心 圆直径 Diam. Of Bolt Circle	螺栓孔 直径 Diam. of Bolt Holes	螺栓孔 数量 No. of Bolt Holes	螺栓尺寸 Diam. of Bolt (inch)	法兰厚度 Thickness of Flange	颈部 直径 Diam. Of Hub	法兰高度 Length Through Hub		法兰近似重量(KG) Approximate Weight of Flange	
DN	NPS	A	D	d	K	L	n	Th	C1-4	N	H1	H2	W1	W4
15	1/2	21.3	120	35	82.5	22	4	M20	22.5	38	60	-	3.18	1.78
20	3/4	26.9	130	43	89	22	4	M20	22.5	44	70	-	3.18	2.43
25	1	33.7	150	51	101.5	26	4	M24	29	52	73	82.5	3.86	3.65
(32)	(1 1/4)	42.4	160	63.5	111	26	4	M24	29	64	73	-	4.54	4.27
40	1 1/2	48.3	180	73	124	29.5	4	M27	32	70	83	89	6.36	5.94
50	2	60.3	215	92	165	26	8	M24	38.5	105	102	102	10.9	10.0
(65)	(2 1/2)	76.1	245	105	190.5	29.5	8	M27	41.5	124	105	105	16.34	14.0
80	3	88.9	265	127	203	32.5	8	M30	48	133	117	117	21.8	19.98
100	4	114.3	310	157.5	241.5	35.5	8	M33	54	162	124	124	31.3	29.71
(125)	(5)	139.7	375	186	292	42	8	M39	73.5	197	155	-	59.9	58.82
150	6	168.3	395	216	317.5	39	12	M36	83	229	171	171	74.5	72.5
200	8	219.1	485	270	393.5	45	12	M42	92	292	213	213	123.9	122.8
250	10	273	585	324	482.5	51	12	M48	108	368	254	254	206.1	211.6
300	12	323.9	675	381	571.5	55	16	M52	124	451	283	283	313.3	317.6
350	14	355.6	750	413	635	60	16	M56	133.5	495	298	298	406.5	422.9
400	16	406.4	825	470	705	68	16	M64	146.5	552	311	311	525.0	557.5
450	18	457	915	533.5	774.5	74	16	M70	162	597	327	327	687.2	761
500	20	508	985	584	832	80	16	M76	178	641	356	356	852.6	967
600	24	610	1170	692	990.5	94	16	M90	203.5	762	406	406	1366.8	1561

注释 Note:

①对焊法兰WN;④法兰盖BL

②Welding Neck Flange(WN),④Blind Flange(BL)